



# Permaculture Design Academy



Courses & training  
Curriculum development  
Project facilitation  
Enterprise development





## **New Venture, coming soon!**

Dragons Housing & Worker Co-operative  
Llanrhaeadr Ym Mochnant



# Permaculture 2015: time to make a change

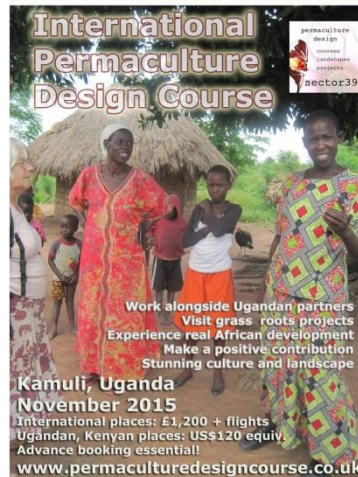
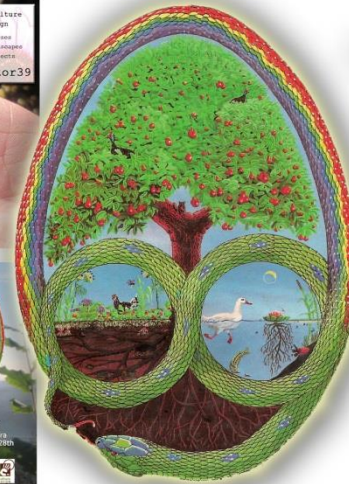

Join the academy  
of change makers





# Get-Growing, Newtown Community Market Gardens





# FOOD WASTE!



**YOU can let  
us compost  
your food  
waste...**

**or you can  
send it to  
landfill**



**The decision is in your hands**

If you'd like to compost your food waste and other  
compostable items,

**PLEASE BE SURE IT GOES  
IN THE CORRECT BIN.**



CWM  
HARRY  
LAND TRUST





























Coleg Harlech WEA(N)  
CAG(G) Coleg Harlech



CWM  
HARRY  
LAND TRUST



# START GARDENING



**The How  
The when  
The why  
In fact all you need  
to  
Know to grow your  
own veg**

**Starts TUESDAY  
7TH SEPTEMBER 9.30-12 at**

**CWM Harry land trust  
Vastre ind.estate**

**NEWTOWN**

**For further information**

Or to book a place

Contact Phil or Cecilia on 01686 610270

Or [powys@fc.harlech.ac.uk](mailto:powys@fc.harlech.ac.uk)

[www.harlech.ac.uk](http://www.harlech.ac.uk)

It's simple - to apply for an Individual Learning Account Wales (ILA Wales), all you have to do is contact learndirect by calling freephone 0800 100 900 and ask for an application form.







Cwm Harry  
Newtown - Powys

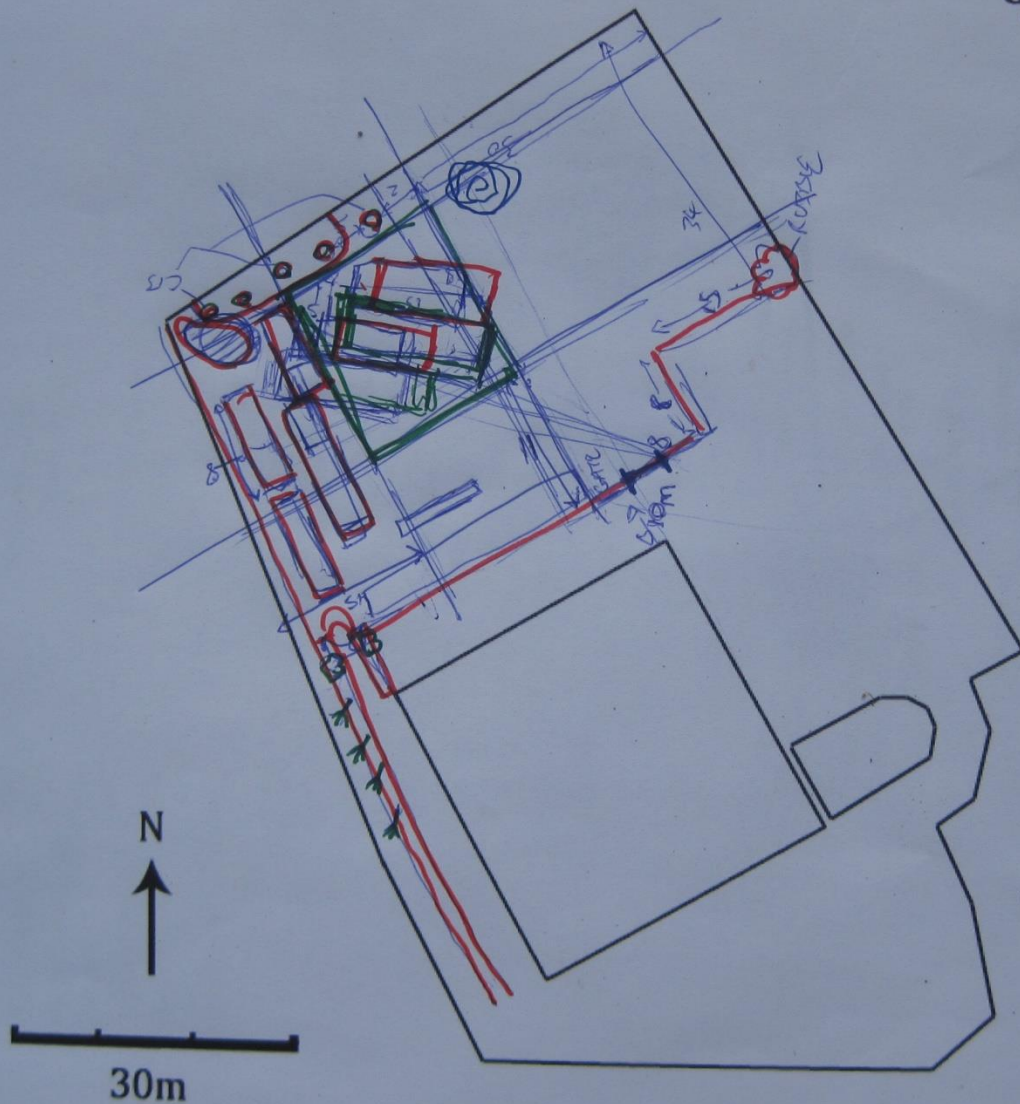







2010  
Jun-Sep Oct-Apr Apr-Sep







## WORKSHOPS, DEMONSTRATIONS + OPEN DAY SUGGESTIONS

	WEEK 1	WEEK 2	WEEK 3	WEEK 4
JUNE	VOLUNTEER DAY	PATHWAY CONSTRUCTION	PATHWAY CONSTRUCTION	SIGN MAKING + INSTALLING (INCLUDING PERMACULTURE TRAIL)
JULY	SHELTER WALLS CONSTRUCTION	LIVING ROOF CONSTRUCTION + PLANTING	OPEN DAY	
AUGUST	TREE PLANTING + TRANSFERING	HERB WORKSHOP + BUILDING HERB SPIRAL		MUSHROOM LOGS
SEPT.	BIRD BOX BUILDING WORKSHOP		WINTER SALAD CROP IN POLY TUNNEL	SEED COLLECTION + SWAP HARVEST DAY



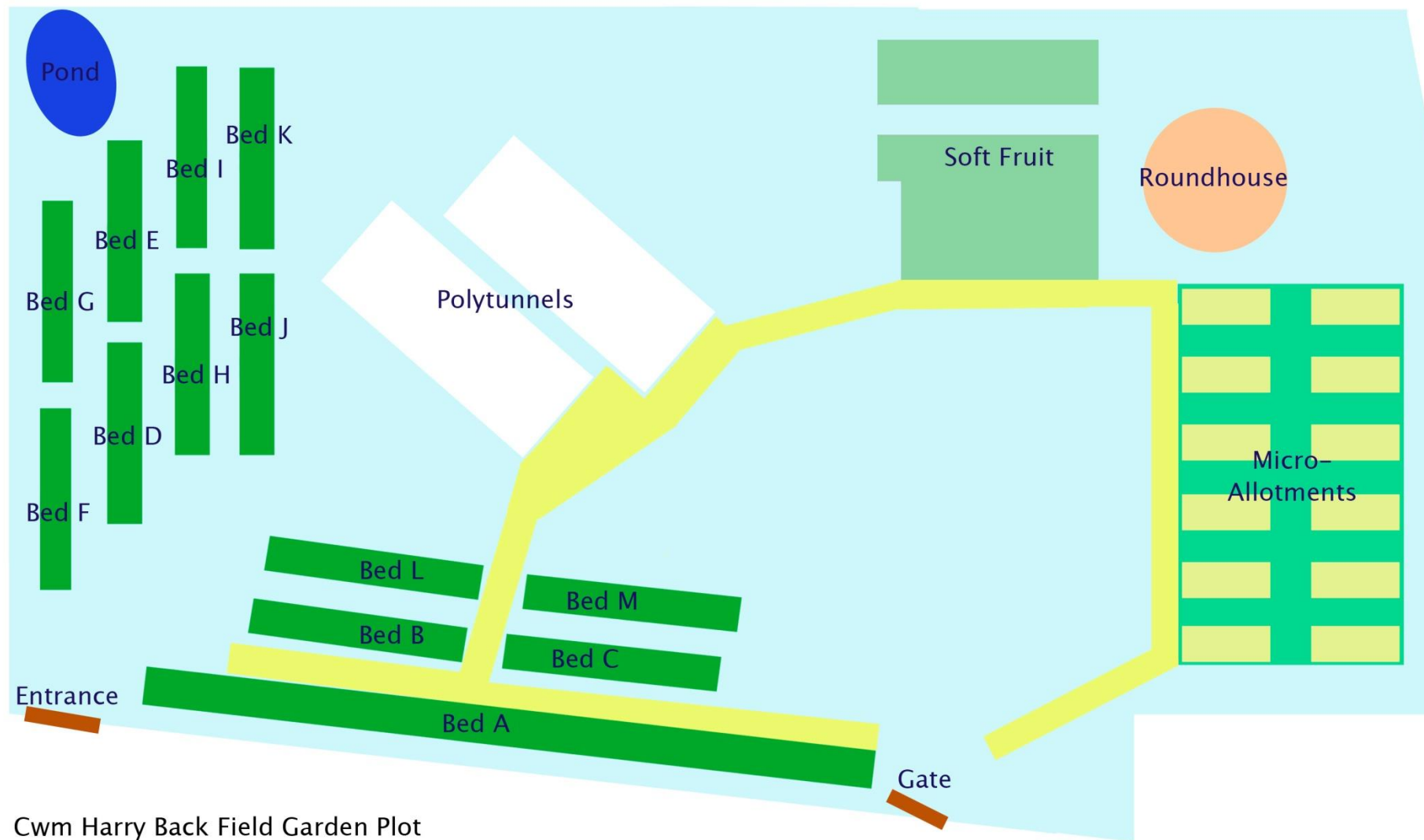

Cwm Harry Back Field Garden Plot  
7 Jan 2011 - v8 - Ian/Sector39

























































































































































































































# Local Food & Growing in Newtown



Sat 25 February  
10am – 3pm



On the High Street, next to Market Hall

- Seed swap & FREE seed starter packs
- Growing advice for all
- FREE micro allotments – find out more!
- Cwm Harry Food Co veg box scheme
- Visit our In Vessel Composting plant and community garden on the Vastre Industrial Estate and bag some
- FREE soil improver made from food waste. Bring your own strong bag!





Rinner Beans

Rinner Beans

Rinner Beans

Rinner Beans

Rinner Beans

Rinner Beans

Rinner Beans

Brood Beans

Brood Beans

French beans  
herbage seed  
'Dishcloth'



# My Kind of Place

Jewellery, Accessories and Gifts







PILGRIM

CWM HARRY  
BAG LLYSIAU  
AT EICH DRWS  
OUR ECOLOGICAL

CWM HARRY  
VEGGIE BAG  
DELIVERY SERVICE

CWM HARRY  
BAG LLYSIAU  
AT EICH DRWS  
OUR ECOLOGICAL

CWM HARRY  
VEGGIE BAG  
DELIVERY SERVICE

CWM HARRY  
BAG LLYSIAU  
AT EICH DRWS  
OUR ECOLOGICAL

CWM HARRY  
VEGGIE BAG  
DELIVERY SERVICE

CWM HARRY  
BAG LLYSIAU  
AT EICH DRWS  
OUR ECOLOGICAL

CWM HARRY  
VEGGIE BAG  
DELIVERY SERVICE

Cwm Harry  
Bwyd  
Cwm Harry  
Food Co

**Tyfu Pobl**  
**Growing People**

Mar's Modernism Homestead  
Growing a Garden (unusual)  
in a city centre  
using a greenhouse  
I started a herb  
garden in a  
back garden  
growing herbs  
for my family  
(great defunct garden)  
Garden

The Garden of the Future  
A Community Garden  
growing herbs and  
vegetables for all  
of us to enjoy  
growing herbs  
for my family  
(great defunct garden)  
Garden

Images of various garden projects and people growing food.

INFORMATION  
SETS









# Get-Growing



[www.get-growing.org.uk](http://www.get-growing.org.uk)



A large orange agricultural sprayer is shown in operation, moving through a lush green field. The machine has a prominent white tank with the brand name 'jacto' visible. It is equipped with long, horizontal spray booms that extend across the width of the field. The background shows a clear blue sky with some light clouds. The overall scene depicts industrial-scale farming.

# Food Myth:

Industrial Agriculture  
is the only way to feed the world.



## Comparison of Food and Oil Prices

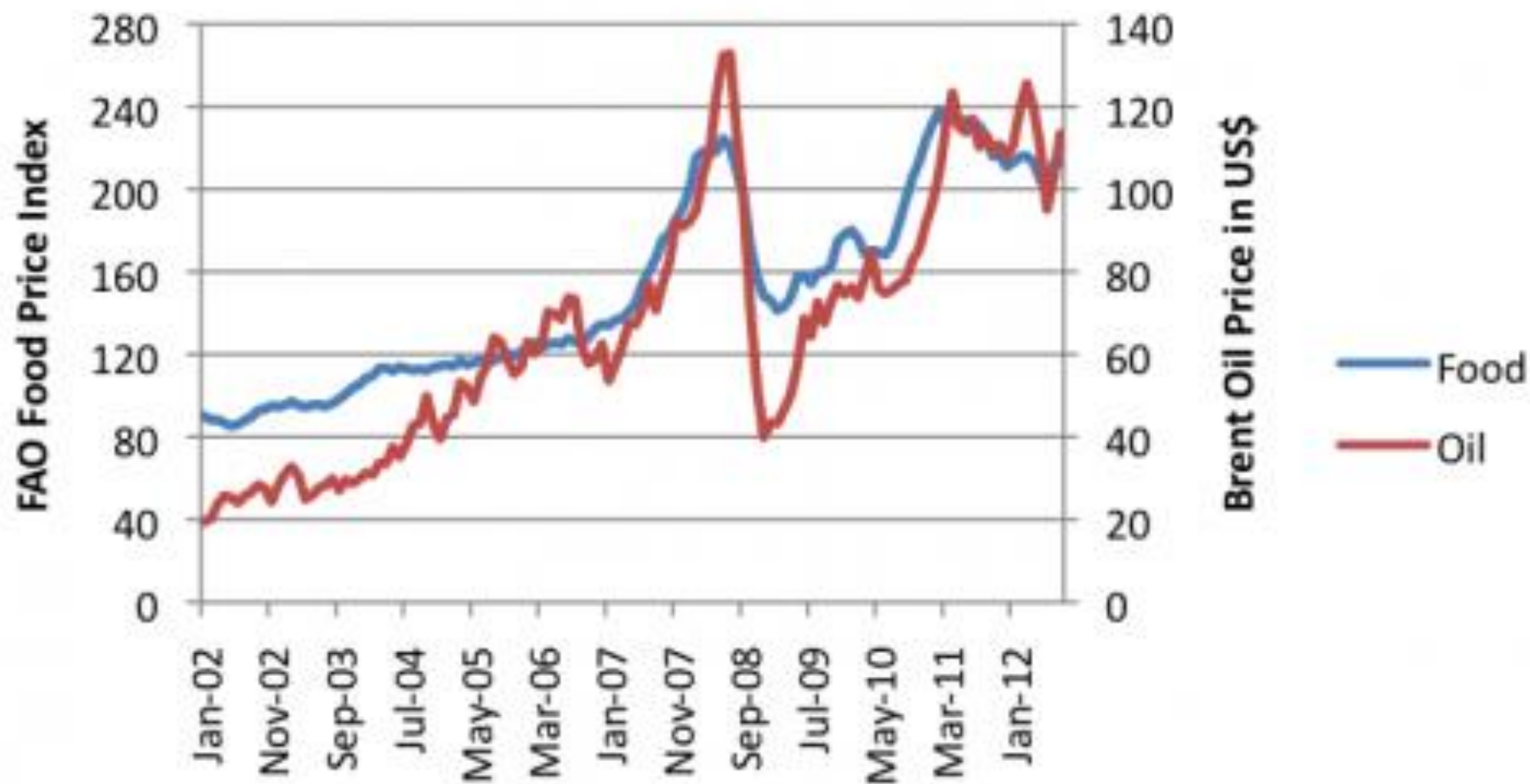









**ONE WAY**

A black rectangular sign with rounded corners and a white border. A white horizontal bar across the center contains the text 'ONE WAY' in bold black capital letters. To the right of the text is a large white arrow pointing to the right. The sign is mounted on a green post with two silver screws.

**ANOTHER WAY**

A black rectangular sign with rounded corners and a white border. A white horizontal bar across the center contains the text 'ANOTHER WAY' in bold black capital letters. To the left of the text is a large white arrow pointing to the left. The sign is mounted on a green post with two silver screws.























# Community Garden Design

A 5-day intensive course, at Coleg Powys,  
Newtown, for all community growers.

Led by Emma Maxwell and Steven Jones.

£140.00 - booking now, July 16th-20th

Bursary's available for local participants

[get-growing.org.uk](http://get-growing.org.uk)

Learn the basics of garden design, horticulture,  
permaculture and group work to produce a real  
design for implementation













# Cwm Harry Get-Growing Garden

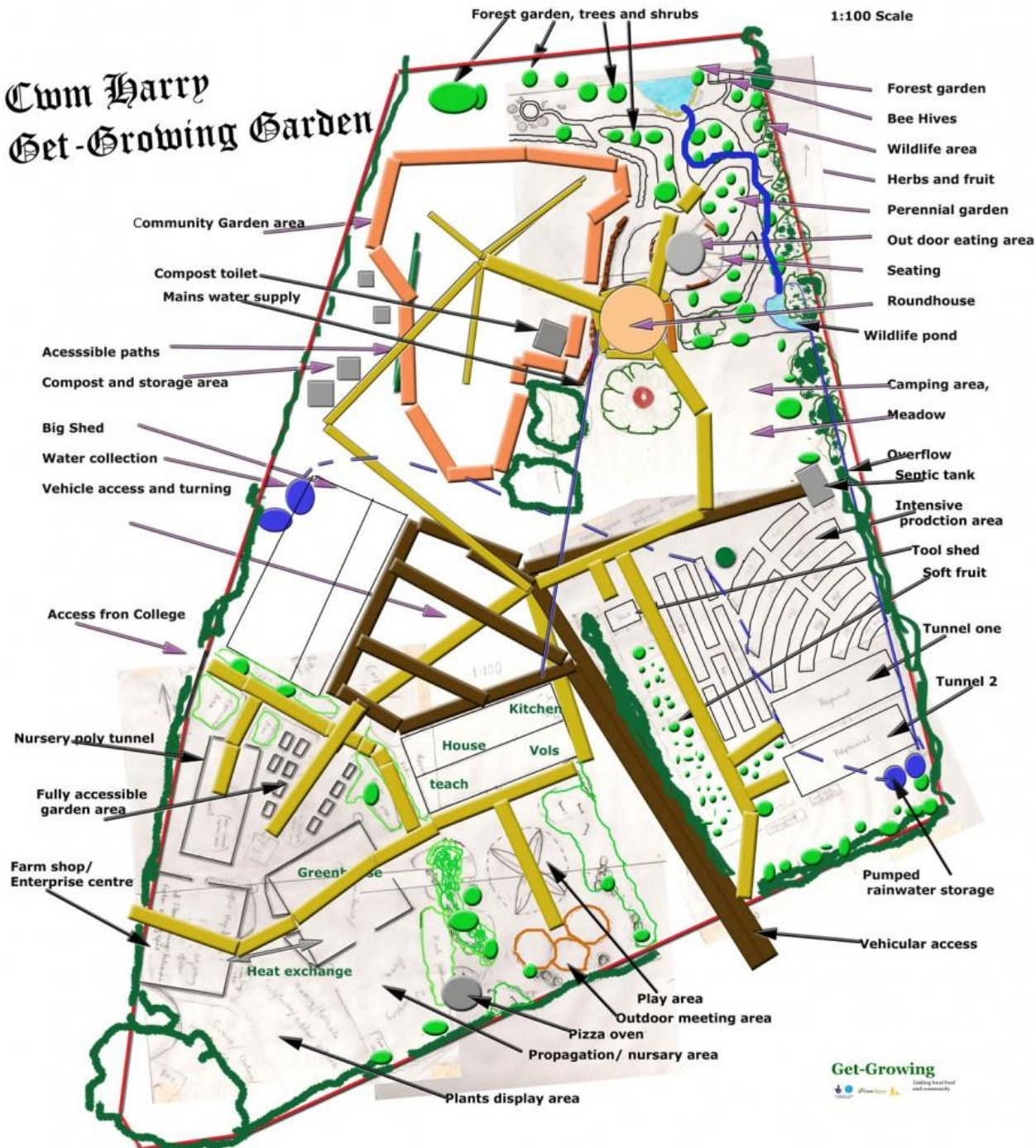







it has most definitely helped me get to where I am now. I have recently been awarded a

Powys has to be the opportunity I was given to go abroad to do a placement through a

pleased for her and it just shows what a little hard work can achieve."

If you would like to be part of the next series of events please contact Mandy on 01588 630683 or e-mail [mandy@lightfoot.org.uk](mailto:mandy@lightfoot.org.uk)



## Get Growing plan takes root

THE Get-Growing Project planted a symbolic Black Mulberry Tree in the main garden and teaching space at the project's base at Pen Dinas in Newtown, based on the Coleg Powys' Newtown campus. The project is aimed at developing a community market garden, with wildlife and play areas. Planting the tree at the project's open day on Wednesday, November 14, are, from left, Lee Davies (estate manager), Edward Gwillim (director of finance and corporate service at Coleg Powys), Adam Kennerley (Cwm Harry chief executive) and County Councillor Graham Brown.

Picture: Rob Davies  
RD341\_2012-1

### Send us your news

- Email – [news@countytimes.co.uk](mailto:news@countytimes.co.uk)
- Visit – [www.countytimes.co.uk](http://www.countytimes.co.uk)
- Write to – 11c Broad Street, Welshpool, Powys, SY21 7LE

for is DOMINIC ROBERTSON. Contact 01938 553354 or email [dominic.robertson@countytimes.co.uk](mailto:dominic.robertson@countytimes.co.uk)



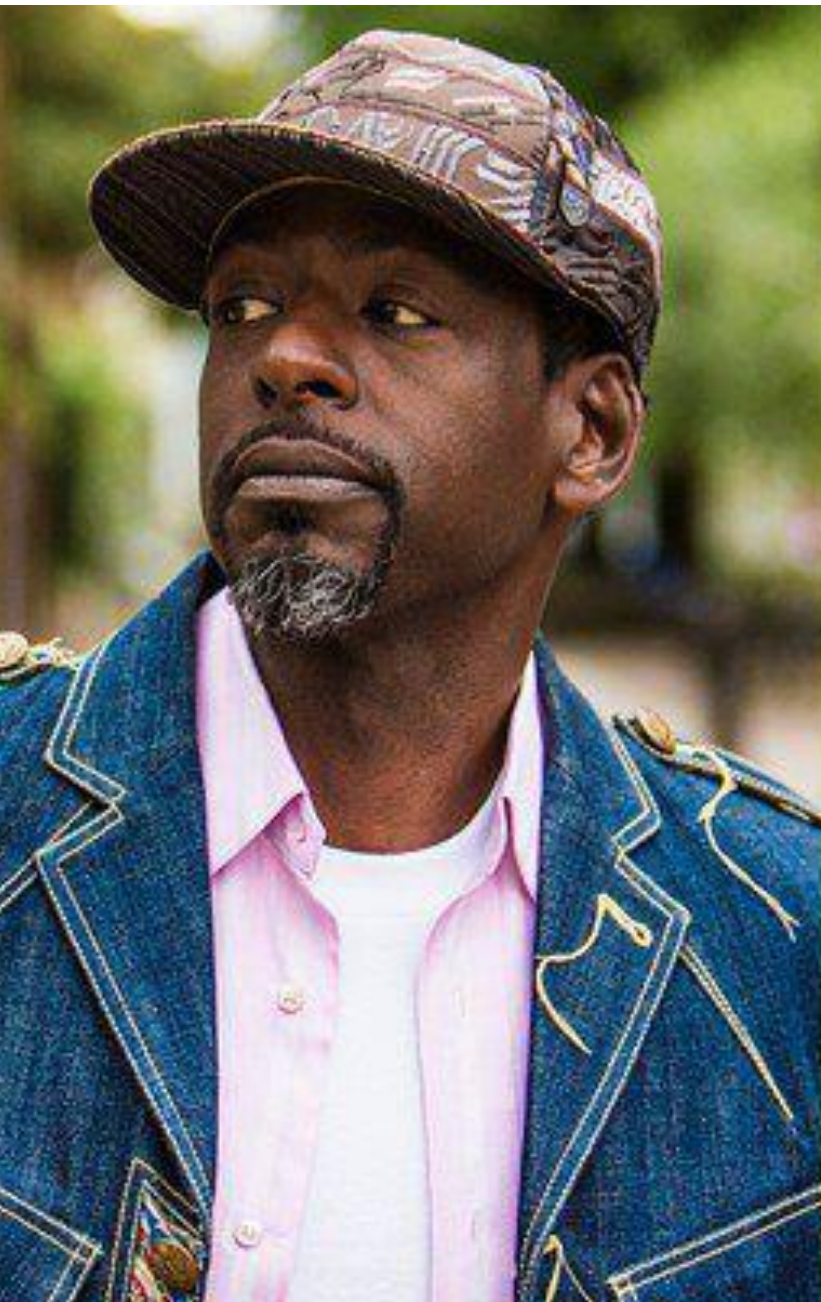

**"Growing your  
own food  
is like  
printing your  
own money"**

**Ron Finley**































# Radnor Raised Beds

A durable & attractive growing system

Follow our live support blog for organic growing success!



Community Enterprise in Newtown, Powys

















# Get-Growing

linking local food and community

## Greenwood carpentry

### A one day course

£35- £20 April 6th

Discount for low income/ Students

*For gardeners and hobbyists*

- . Learn basic hand tool use
- . Make garden furniture
- . Make & keep stool & bench
- . Lively practical session

With Ritchie Stephenson

Full course list and updates plus regular blog posts

[www.get-growing.org.uk](http://www.get-growing.org.uk)

At Pen Dinas, Llanidloes Road,  
Newtown, SY16 1HX



ARIENNIR GAN Y LOTERI  
LOTTERY FUNDED



Cwm Harry  
Local Growing









## Grafting

### When to Graft

Most grafting is done during winter and early spring while plants are dormant. Containerized plants may be moved indoors in late fall. These plants are placed in a cold frame or greenhouse.

















































































FOREST  
GARDEN

















FOREST  
GARDEN

































S10P









Herbs

Herbs

Small £1.50

med £2.50

lg £3.50

Herbs Small































